

Metal Siding

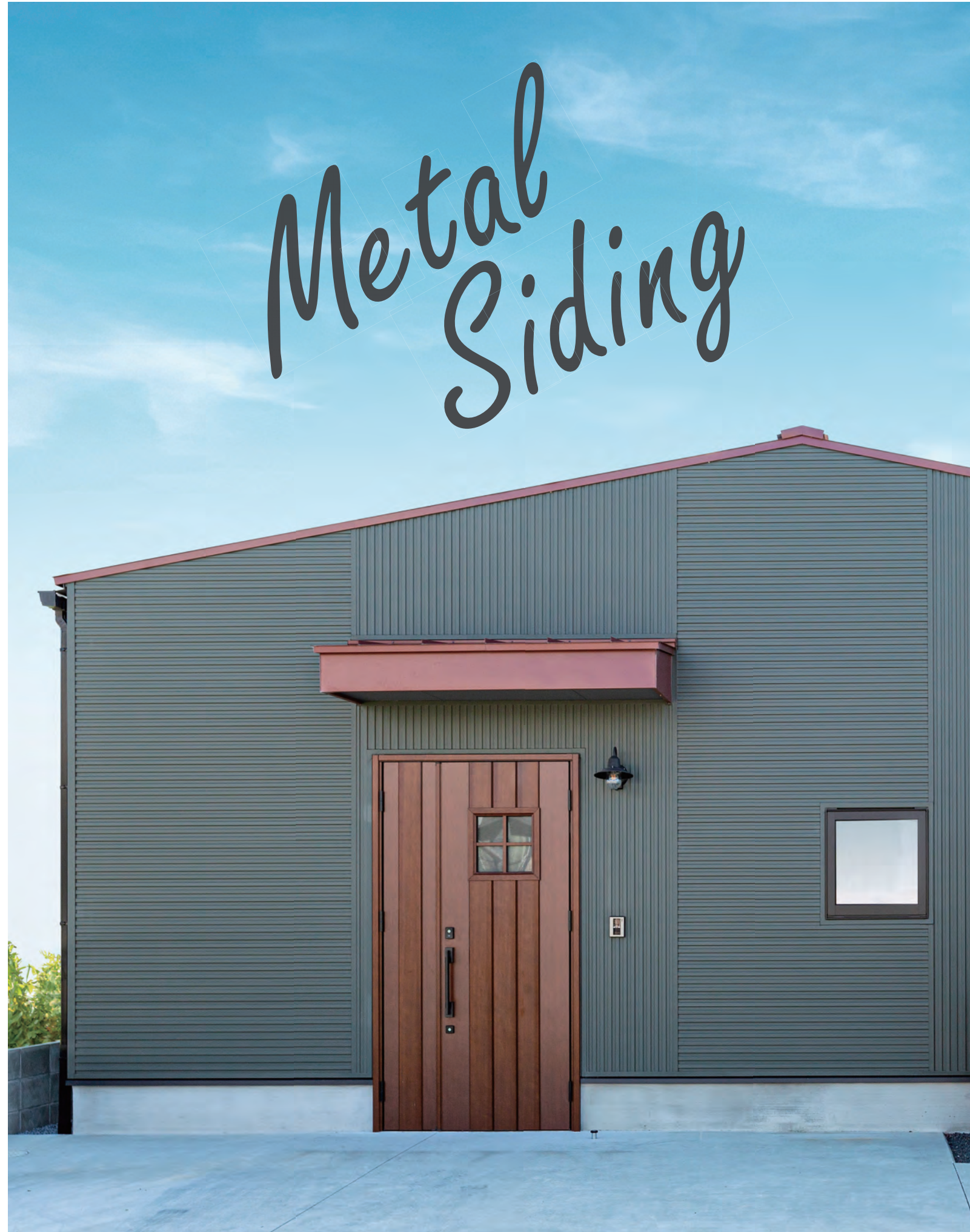

Under the corporate slogan
“Building a Better Human Environment,”
we are committed to contributing to
achieving a recycling-oriented
society.

Founded in 1956 as a hardboard manufacturer that made effective use of wood offcuts, Nichiha is the leading company for fiber cement sidings in the Japanese market, and a rising challenger creating new market value worldwide.

Even for metal products made of different materials, we will continue new initiatives aimed at coexistence with the environment and delivering long-life housing.

Contents

1-2	Introduction
3-5	Product Overview & Features
6-10	Case Study
11-16	Product Introduction
17-18	Contact & Corporate Information



Structure of Nichiha metal siding

1 A three-layer structure offering excellent durability and thermal insulation.

Nichiha's metal siding is a high-performance exterior wall material with insulation material sandwiched (integrally molded) between the surface material and backing material. Suitable for everything from new construction to renovations; choose a type to suit your application.

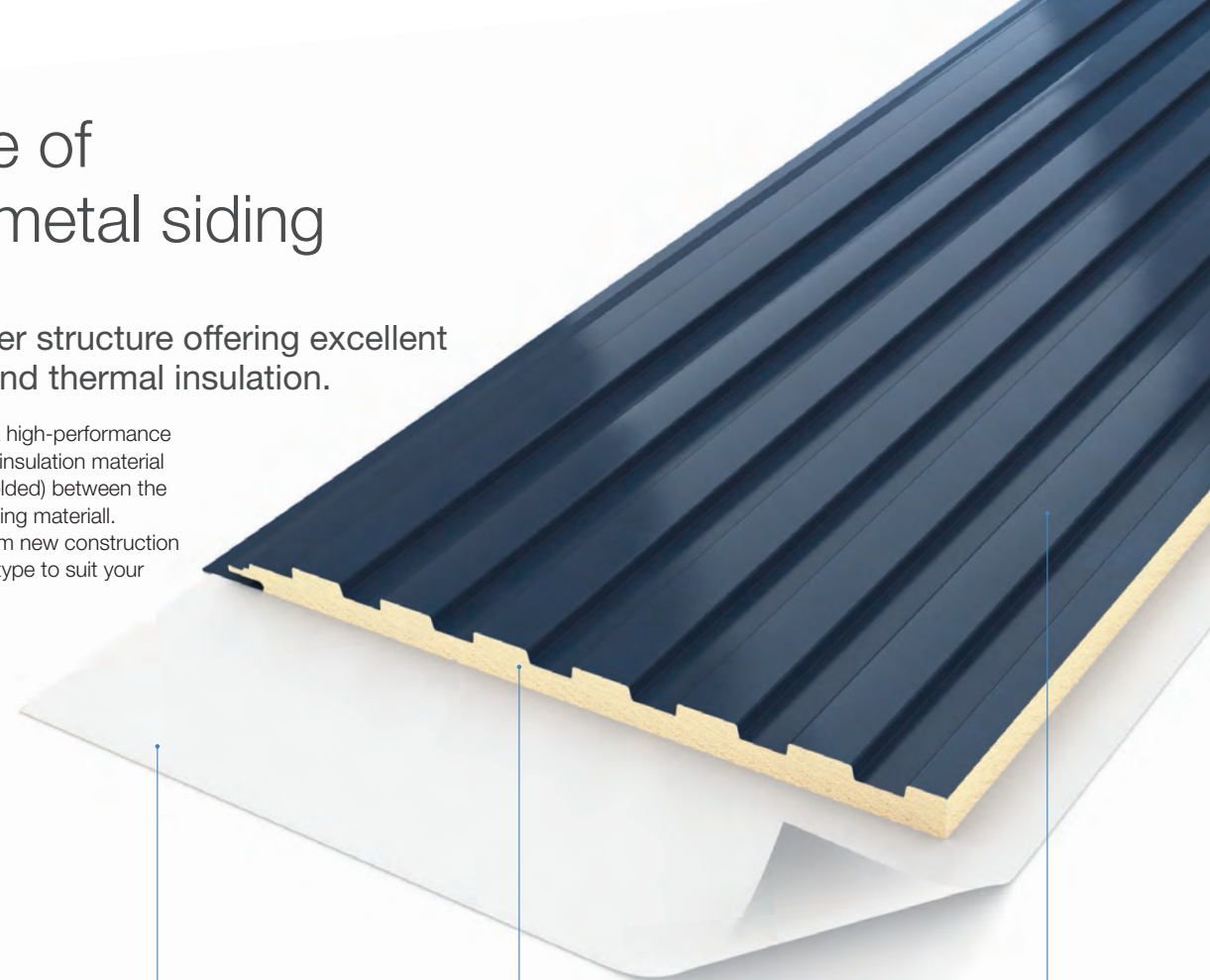

Backing Material

Aluminum-laminated Paper
In addition to increasing the strength of the exterior wall material, Aluminum-laminated Paper reflects radiant heat to help keep indoor temperatures comfortable.

Insulation Material (Core)

Rigid Polyurethane Foam or Polyisocyanurate Foam (PIR Foam)
Made using a core material with excellent thermal insulation and soundproofing.

Surface Material

Prepainted High Corrosion-resistant Galvalume Steel Sheet (Hot-dip 55% aluminum-zinc alloy coated steel sheet)

55% Aluminum-zinc alloy coated steel sheet. Compared with general zinc-coated steel sheet, corrosion resistance is significantly improved.

Surface material specifications

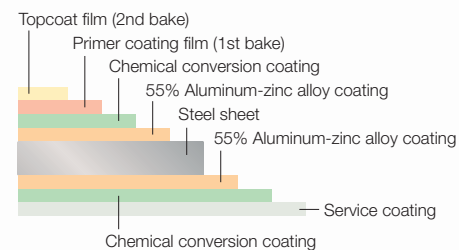

2 Prepainted High Corrosion-resistant Galvalume Steel Sheet has an approximately 3-6 times longer service life than general zinc-coated steel sheet.

The plated layer of Prepainted High Corrosion-resistant Galvalume Steel Sheet has a structure in which a zinc-rich layer surrounds an aluminum-rich layer in a mesh pattern. With a plated-layer composition that maximizes zinc's sacrificial corrosion protection¹ and aluminum's passivation protection², it delivers exceptionally high corrosion resistance. Prepainted High Corrosion-resistant Galvalume Steel Sheet also delivers high durability at the edges of the steel sheet.

¹ Zinc and iron with different ionization tendencies come into contact, and the zinc dissolves. Preventing oxidation of the steel sheet itself.
² A condition in which an oxide film forms on the metal surface, protecting it from corrosion and oxidation.

Surface structure of Prepainted High Corrosion-resistant Galvalume Steel Sheet

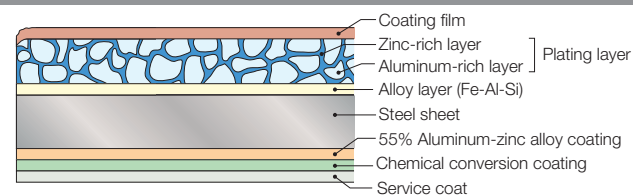

Plated-layer composition of high corrosion-resistant Galvalume steel sheet

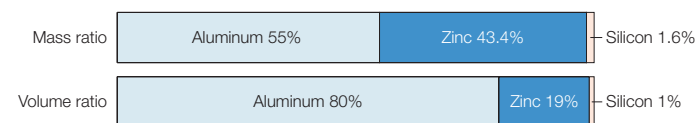

For peace of mind and comfort Basic Performance

1 Earthquake resistance

Significantly reduces the weight of the house.

The weight of Nichiha metal siding is about 1/10 that of mortar. For houses with equivalent structural frameworks, Nichiha metal siding is less susceptible to earthquake impacts, reducing the load on the building. For example, when comparing three-story houses by structural type, a lightweight wooden house is said to be subjected to only about 14 tons of seismic force, whereas a heavy reinforced-concrete house is said to be subjected to about 70 tons of seismic force—nearly five times that of a wooden house.

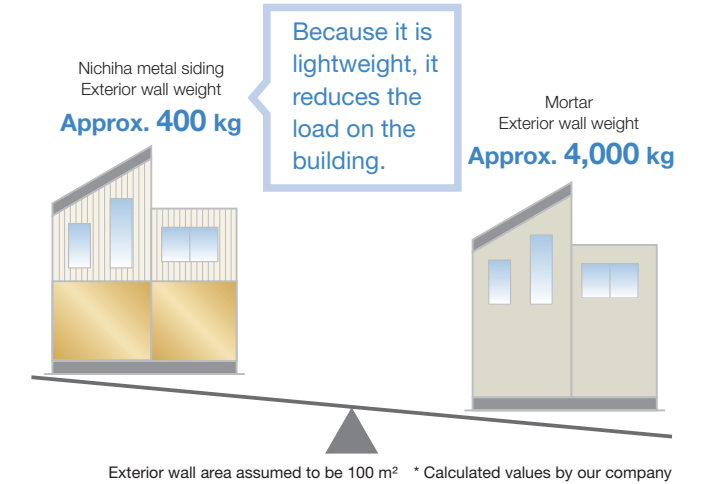

Sliding at interlocking joints absorb deformation.

Nichiha metal siding is installed by fixing one side and interlocking the other. This allows deformation of the exterior wall caused by earthquake shaking to be absorbed by sliding at the interlocking joint, dissipating the earthquake force. Nichiha metal siding does not crack like mortar or concrete construction.

Shaking during an earthquake

Nichiha metal siding
The interlocking joints flexibly respond to earthquake shaking.
Damage and detachment are less likely to occur.

Mortar
There is a possibility of cracking due to earthquake shaking.

Interlocking joint details

Interstory drift test | A test that reproduces the strain that occurs when an earthquake happens * Measured values by our company

Deformation angle 1/50

Deformation angle 1/15

During testing (absorbed by sliding)

2 Rain Screen System

Maintains exterior wall performance over the long term.

A "Rain Screen System" is a method that creates a ventilation layer (an air passage) behind the exterior wall material to release and dry out moisture and heat, preventing condensation within the wall. Providing a ventilation layer also improves heating and cooling efficiency. The system improves housing durability while providing a comfortable living environment.

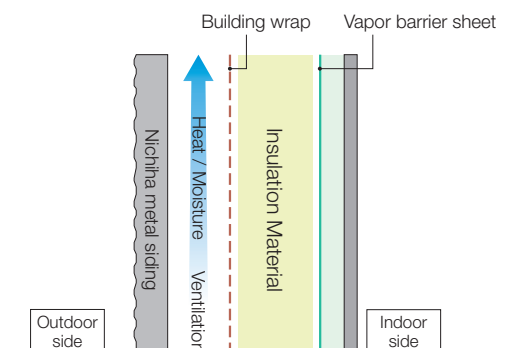

Heat-reflective Fluoropolymer-coated Steel Sheet

1 Molecular bonding strength is stronger than ultraviolet rays.

Fluoropolymer-coated High Corrosion-resistant Galvalume Steel Sheet can protect exterior wall materials more effectively than general prepainted steel sheets, because it has stable bonding energy that exceeds the ultraviolet energy that causes fading.

Bond energy comparison

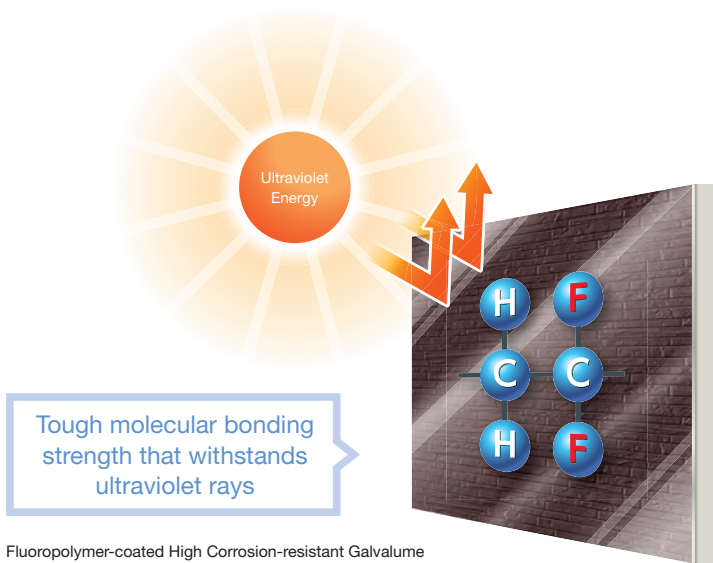
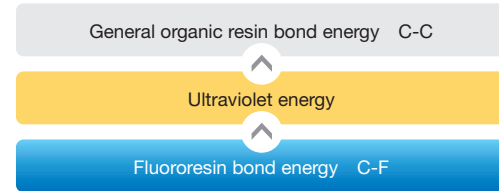

Fluoropolymer-coated High Corrosion-resistant Galvalume Steel Sheet is a steel sheet that forms a coating film where the fluororesin and acrylic resin are in a compatible state.

2 Outstanding durability

Exterior wall materials are exposed to harsh natural environments such as strong sunlight and heat, snow, and long periods of rain. In Japan, it is generally said that the surface coating film deteriorates in about 5–7 years and needs repainting. Given that Fluoropolymer-coated High Corrosion-resistant Galvalume Steel Sheet is used, it is expected to suppress discoloration and fading for a longer period.

* Durability varies depending on climate conditions at the installation site, etc.

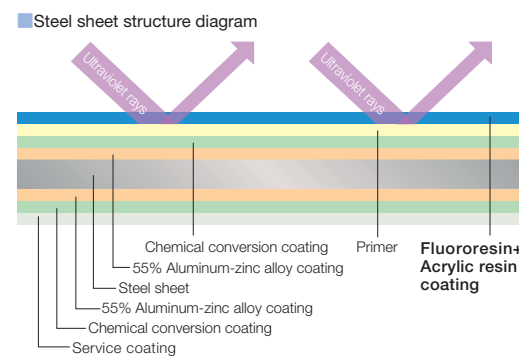

3 Excellent Heat-shielding Performance

A comparison of the rear-surface temperature of a general steel sheet with that of Fluoropolymer-coated High Corrosion-resistant Galvalume Steel Sheet reveals a temperature difference of about 10°C, and Nichiha metal siding is expected to significantly reduce increases in indoor temperature.

Fluoropolymer-coated High Corrosion-resistant Galvalume Steel Sheet has a higher solar reflectance than general steel sheets, indicating that it is less likely to absorb solar energy. In particular, the two dark colors—black and brown—are particularly effective.

Results of a simplified test of the rear-surface temperature difference between general steel sheet and Fluoropolymer-coated High Corrosion-resistant Galvalume Steel Sheet

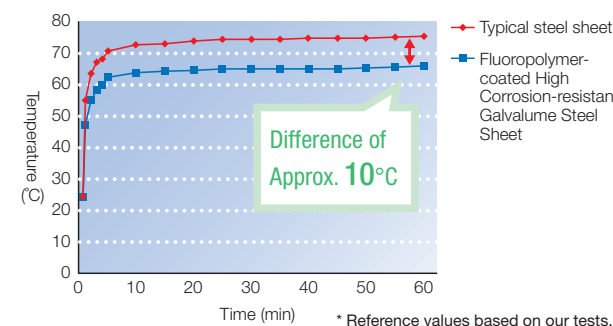

Test method: At a room temperature of 18–19°C, a light source (halogen lamp) is placed 20 cm from the product and compared for 60 minutes. Specimens: General steel sheet (color: black), Fluoropolymer-coated High Corrosion-resistant Galvalume Steel Sheet (color: deep black)

Solar reflectance of general steel sheet and Fluoropolymer-coated High Corrosion-resistant Galvalume Steel Sheet (our test measurement data)

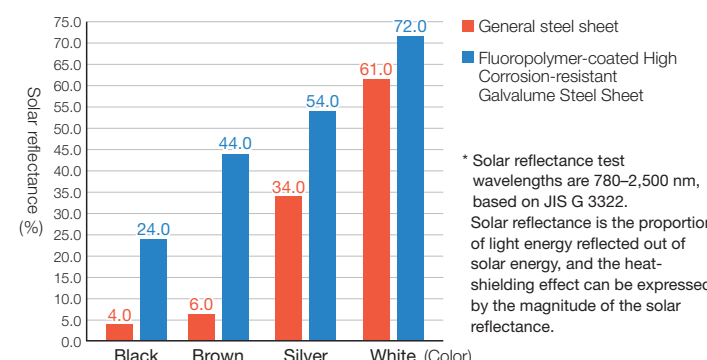

Specimens: General steel sheet (colors: black, brown, silver, white), Fluoropolymer-coated High Corrosion-resistant Galvalume Steel Sheet (colors: deep black, mist brown, light metallic silver, deep white)

Case Study

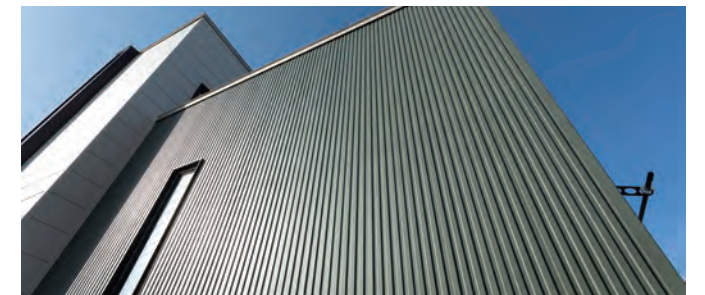

* Photos are for illustrative purposes.

New Construction Residential | 01

A simple yet impactful exterior design

The light gray flat pattern and green span pattern are neatly and beautifully arranged in blocks, and tightened up with black window sashes. EPS494□X used around south-facing tall vertical slit windows become a focal point, creating a simple yet high-impact exterior design.



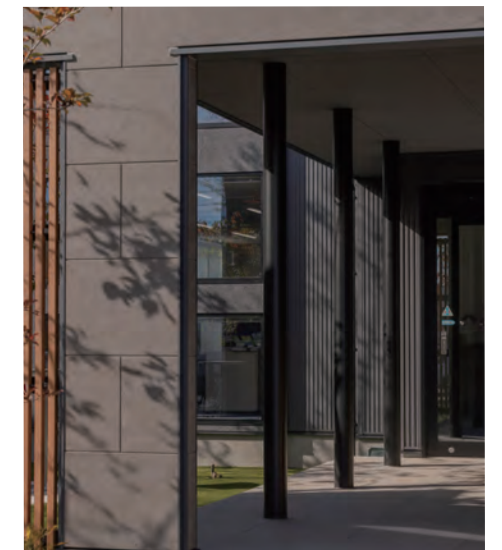

* Photos are for illustrative purposes.

* Photos are for illustrative purposes.

New Construction | Residential | 02

One-of-a-kind presence created through differences in texture and design

With the exception of windows and exterior fittings, on north walls facing the road, the use of an overhang to create a three-dimensional form brings out the sharp look of the metal. EFM508□X blends into any space; paired with a Stack Bond pattern, it expresses lasting stability in daily living and future potential.

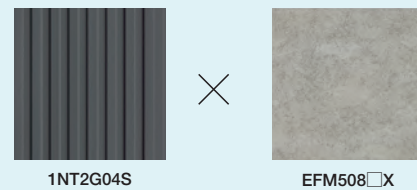

New Construction | Non-residential | 03

Exquisite Combinations that Elevate Spatial Comfort

The matte mist black finish blends seamlessly into a serene atmosphere, creating a calm and grounded impression. By coordinating muted tones, the exterior achieves a sophisticated, timeless aesthetic that develops a rich character over time.

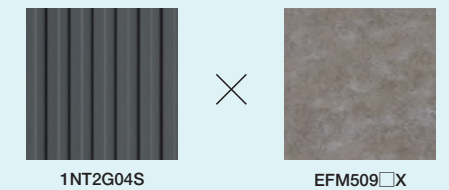



* Photos are for illustrative purposes.



BEFORE



* Photos are for illustrative purposes.

Renovation | 01
Non-residential

Mid- and high-rise building renovations expanding in scope

Offering sharp design features, these metal sidings blend in with the tall building to transform it into a refined atmosphere. The 1st floor is finished in a gunmetal tone (1NS2G02A), and from the 2nd floor upward in crisp white (1NS2G029), creating both openness and a sense of stability.



1NS2G029

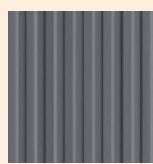

1NS2G02A

Renovation | 02
Non-residential

An exterior design balancing boldness and a sense of solidity

Using black and brown on the lower portion of the building creates a dynamic look. Using two metallic silver colors on the upper floors brings about a stylish yet bold exterior.



1CT2G087

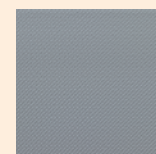

1CT2G088



1CM2G04D

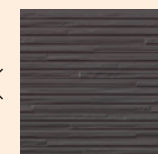

1RH1KD3K



BEFORE

Heat-reflective
Fluoropolymer-coated Steel Sheet

Thickness
18
mm



Slimmer raised sections to create a sharp appearance.
Rated with various fire-resistant structure certification numbers in Japan, supporting a wide range of applications.



Heat-reflective
Fluoropolymer-coated
Steel Sheet

Certified in Japan
■ Noncombustible
Material Certification
No. NM-5638
(When using the steel-sheet
side of the siding surface)

1NS2G05E image



1NS2G029

* Photos are for illustrative purposes.

■ Main Unit Specifications *1 Manufacturing method using a non-CFC foaming agent.

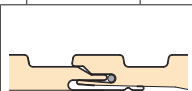
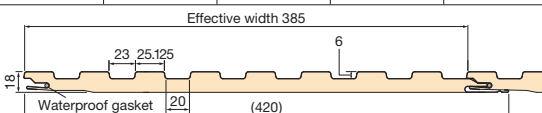
Surface Material	Fluoropolymer-coated High Corrosion-resistant Galvalume Steel Sheet (thickness 0.35 mm)	Thickness	Effective Width	Length: Standard	Area per Sheet	Qty per Package	Area per Package	Package Weight*	Weight per Sheet
		18 mm	385 mm	3,000 mm	1.16 m ²	6 Sheets	6.93 m ²	Approx. 36 kg	Approx. 5.7 kg
Core Material	Polyisocyanurate Foam (PIR Foam) (HFO*1)	Interlocking Condition		Shape Dimension drawing (mm)					

* Package weight includes the weight of packaging materials.

Precautions

- Matte-color products may be difficult to clean due to their characteristics.
- With dark-colored products, color transfer may occur, but this is not an abnormality of the coating film.
- Panel joints may be noticeable depending on the viewing direction and lighting.
- As this is printed material, the colors/patterns may differ from the actual product.



3,000 mm (Pack of 6 sheets)



3,000 mm (Pack of 6 sheets)

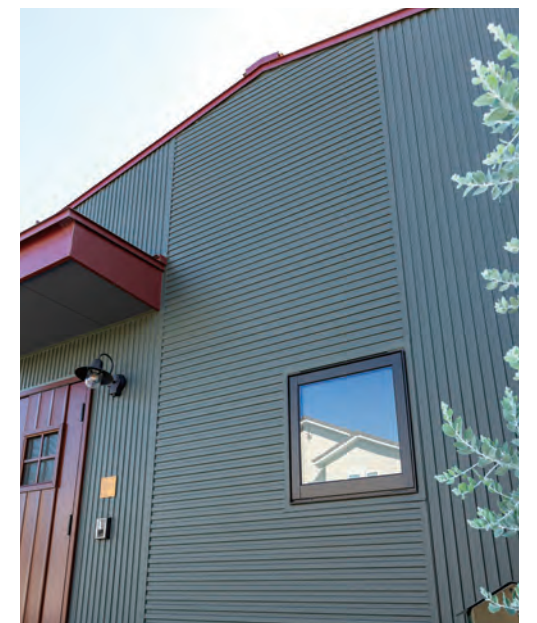

* Photos are for illustrative purposes.

[How to Use Accessories for Openings]

When using end covers, perimeter trim covers, perimeter steel supports, edge trims, and edge trim corners for openings, please install them using one of the combinations below (excluding the aluminum end cover).

- (1) End Cover / Edge Trim / Edge Trim Corner
 - (2) Perimeter Trim Cover / Perimeter Steel Support / Edge Trim Corner
- * For details, please contact our sales representative.

Precautions

- * In areas affected by heavy snowfall, the end cover and vertical starter may deform under the weight of snow, so we recommend using an aluminum end cover at the base.
- Using an aluminum end cover (for snowy regions) at the vertical joint during vertical installation will fall outside the scope of fire-resistant structure certification (in Japan).
- Matte-color products may be difficult to clean due to their characteristics. ● With dark-colored products, color transfer may occur, but this is not an abnormality of the coating film.
- Please note that for accessories whose color/pattern is "Standard color," the color cannot be specified. ● Panel joints may be noticeable depending on the viewing direction and lighting.
- As this is printed material, the colors/patterns may differ from the actual product.
- When using touch-up paint on surface scratches, etc., apply touch-up only to a very small area. If the coated area is large, the finish may look unnatural.
- We also offer dedicated sealant, but depending on chemical regulations in each country, it might not be available for purchase.

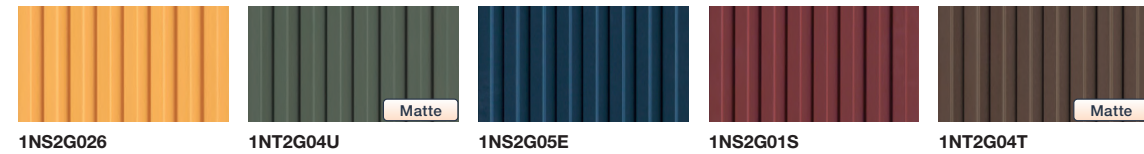
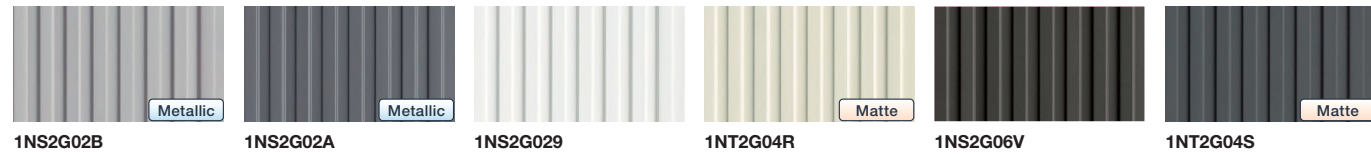

■ Accessories Material: Fluoropolymer-coated High Corrosion-resistant Galvalume Steel Sheet (excluding horizontal starter, aluminum end cover, external corner steel support, joint steel support, perimeter steel support, backer rod, stepped backer rod, and steel flashing component)

For installation methods and processing methods for accessories, please refer to the latest "Design & Installation Data Collection: Metal Exterior Wall & Roofing Materials — Standard Installation Edition."

Product Name	Flashing 34	Horizontal Intermediate Flashing 18	Horizontal Starter	Vertical Starter *	End cover *	Aluminum end cover *
Shape Dimension Drawing						
Length	3,030 mm	3,030 mm	3,030 mm	Effective width: 3,030 mm	Effective width: 3,030 mm	3,030 mm
Qty per Package	20 Pcs/carton	5 Pcs/carton	20 Pcs/carton	10 Pcs/carton	10 Pcs/carton	5 Pcs/carton
Color/pattern	Same color as main unit, flat	Same color as main unit, flat	Standard color	Same color as main unit, flat	Same color as main unit, flat	3 colors below
1NS2G02B	AMZ7F02B	ATM6F02B	AST2F00A	AST5F02B	AMKHF02B	AMKDF09J (Light Silver) AMKDF09H (White) AMKDF09G (Black)
1NS2G02A	AMZ7F02A	ATM6F02A		AST5F02A	AMKHF02A	
1NS2G029	AMZ7F029	ATM6F029		AST5F029	AMKHF029	
1NT2G04R	AMZ7F04R	ATM6F04R		AST5F04R	AMKHF04R	
1NS2G06V	AMZ7F06V	ATM6F06V		AST5F06V	AMKHF06V	
1NT2G04S	AMZ7F04S	ATM6F04S		AST5F04S	AMKHF04S	
1NS2G026	AMZ7F026	ATM6F026		AST5F026	AMKHF026	
1NT2G04U	AMZ7F04U	ATM6F04U		AST5F04U	AMKHF04U	
1NS2G05E	AMZ7F05E	ATM6F05E		AST5F05E	AMKHF05E	
1NS2G01S	AMZ7F01S	ATM6F01S		AST5F01S	AMKHF01S	
1NT2G04T	AMZ7F04T	ATM6F04T	AST5F04T	AMKHF04T		

▲The end cover and aluminum end cover can be used as starters for vertical installation.

Product Name	External corner cover (3,030 mm)	External corner steel support	Stepped joint	Joint cover	Joint Steel Support
Shape Dimension Drawing					
Length	Effective width: 3,030 mm	Effective width: 3,030 mm	Effective width: 385 mm	Effective width: 3,030 mm	Effective width: 3,030 mm
Qty per Package	10 Pcs/carton	10 Pcs/carton	40 Pcs/carton	10 Pcs/carton	10 Pcs/carton
Color/pattern	Same color as main unit, flat	Standard color	Same color as main unit, same shape	Same color as main unit, flat	Standard color
1NS2G02B	ADS2F02B	ADU7F00A	ADM5F02B	AMJ3F02B	AMU6F00A
1NS2G02A	ADS2F02A		ADM5F02A	AMJ3F02A	
1NS2G029	ADS2F029		ADM5F029	AMJ3F029	
1NT2G04R	ADS2F04R		ADM5F04R	AMJ3F04R	
1NS2G06V	ADS2F06V		ADM5F06V	AMJ3F06V	
1NT2G04S	ADS2F04S		ADM5F04S	AMJ3F04S	
1NS2G026	ADS2F026		ADM5F026	AMJ3F026	
1NT2G04U	ADS2F04U		ADM5F04U	AMJ3F04U	
1NS2G05E	ADS2F05E		ADM5F05E	AMJ3F05E	
1NS2G01S	ADS2F01S		ADM5F01S	AMJ3F01S	
1NT2G04T	ADS2F04T	ADM5F04T	AMJ3F04T		

Product Name	Perimeter trim cover	Perimeter steel support	Edge trim	Edge trim corner	Angle 20×40	Matching Metal Sheet
Shape Dimension Drawing						
Length	Effective width: 3,030 mm	Effective width: 3,030 mm	Effective width: 3,030 mm	—	3,030 mm	1,000 mm×10 m
Qty per Package	10 Pcs/carton	10 Pcs/carton	20 Pcs/carton	50 Pcs/carton	10 Pcs/carton	1 Roll/carton
Color/pattern	Same color as main unit, flat	Standard color	Same color as main unit, flat	Same color as main unit, flat	Same color as main unit, flat	Same color as main unit, flat
1NS2G02B	AMW8F02B	AMWCF00A	AMKGF02B	AMC4F02B	AAN8F02B	ECL1F02B
1NS2G02A	AMW8F02A		AMKGF02A	AMC4F02A	AAN8F02A	ECL1F02A
1NS2G029	AMW8F029		AMKGF029	AMC4F029	AAN8F029	ECL1F029
1NT2G04R	AMW8F04R		AMKGF04R	AMC4F04R	AAN8F04R	ECL1F04R
1NS2G06V	AMW8F06V		AMKGF06V	AMC4F06V	AAN8F06V	ECL1F06V
1NT2G04S	AMW8F04S		AMKGF04S	AMC4F04S	AAN8F04S	ECL1F04S
1NS2G026	AMW8F026		AMKGF026	AMC4F026	AAN8F026	ECL1F026
1NT2G04U	AMW8F04U		AMKGF04U	AMC4F04U	AAN8F04U	ECL1F04U
1NS2G05E	AMW8F05E		AMKGF05E	AMC4F05E	AAN8F05E	ECL1F05E
1NS2G01S	AMW8F01S		AMKGF01S	AMC4F01S	AAN8F01S	ECL1F01S
1NT2G04T	AMW8F04T	AMKGF04T	AMC4F04T	AAN8F04T	ECL1F04T	

Product Name	Steel Flashing Component	Single-sided Waterproof Tape	CS Backer Rod	Stepped backer rod	Sealant	Touch-up Paint
Shape Dimension Drawing						
Length	3,030 mm	100 mm×20 m	2,000 mm	385 mm	—	—
Qty per Package	10 Pcs/carton	1 Roll/bag	100 Pcs/carton	50 Pcs/carton	10 Pcs/carton (320 mL/pc)	1 Pc (15 mL/pc)
Color/pattern	Black	—	Black	Black	Main unit similar color	Main unit similar color
1NS2G02B	KE5100	JF1526	ABK5Q0J3	ABK8Q0JL	DSY1Q0KB	DPA4Q0Q3
1NS2G02A					DSY1Q0KA	DPA4Q0Q2
1NS2G029					DSY1Q0KD	DPA4Q0Q1
1NT2G04R					DSY1Q0N8 (Ivory White)	DPA4Q0S4
1NS2G06V					DSY1Q0K1 (Black)	DPA4Q0UV
1NT2G04S					DSY1Q0KS	DPA4Q0S5
1NS2G026					DSY1Q0KF	DPA4Q0PX
1NT2G04U					DSY1Q0KU	DPA4Q0S7
1NS2G05E					DSY1Q0ND	DPA4Q0SK
1NS2G01S					DSY1Q0LJ	DPA4Q0PR
1NT2G04T	DSY1Q0KT	DPA4Q0S6				

Thickness
18
mm

For vertical installation only

A simple design that is not influenced by the times. A long-selling product featuring rhythmic joints.



1AC1G558 image

■ Main Unit Specifications

Surface Material	Polyester-Prepainted High Corrosion-resistant Galvalume Steel Sheet (Thickness 0.27 mm)	Thickness	18 mm	Effective Width	241 mm	Length	3,048 mm	Area per Sheet	0.74 m ²	Qty per Package	12 Sheets	Area per Package	8.82 m ²	Package Weight*	Approx. 33 kg	Weight per Sheet	Approx. 2.6 kg
Core Material	Rigid Polyurethane Foam	Interlocked state			Shape Dimension drawing (mm)												

* Package weight includes the weight of packaging materials.



3,048 mm 1AC1G548 1AA1G547 1AC1G545 1AC1G559 1AA1G55A



3,048 mm 1AA1G54W 1AC1G558

Precautions

- * In areas affected by heavy snowfall, the End cover and Vertical Starter may deform under the weight of snow, so we recommend using an Aluminum end cover at the base.
- Using an Aluminum end cover (for snowy regions) at the vertical joint during vertical installation will fall outside the scope of fire-resistant structure certification (in Japan).
- With dark-colored products, color transfer may occur, but this is not an abnormality of the coating film.
- Please note that for accessories whose color/pattern is "Standard color," the color cannot be specified.
- Panel joints may be noticeable depending on the viewing direction and lighting. ● As this is printed material, the colors/patterns may differ from the actual product.
- When using touch-up paint on surface scratches, etc., apply touch-up only to a very small area. If the coated area is large, it may look unnatural.
- We also offer dedicated sealant, but depending on chemical regulations in each country, it might not be available for purchase.

■ Accessories Material: Polyester Prepainted High Corrosion-resistant Galvalume Steel Sheet (excluding Aluminum end cover)

* For installation methods and processing methods for accessories, please refer to the latest "Design & Installation Data Collection: Metal Exterior Wall & Roofing Materials – Standard Installation Edition."

Product Name	Flashing 34	Horizontal Intermediate Flashing 18	End cover *	Aluminum end cover *	Outside Corner	Inside Corner
Shape Dimension Drawing						
Length	3,030 mm	3,030 mm	3,030 mm	3,030 mm	3,030 mm	3,030 mm
Qty per Package	20 Pcs/carton	5 Pcs/carton	10 Pcs/carton	5 Pcs/carton	20 Pcs/carton	10 Pcs/carton
Color/pattern	Same color as main unit, flat	Same color as main unit, flat	Same color as main unit, flat	3 colors below	Same color as main unit, flat	Same color as main unit, flat
1AC1G548	AMZ7F048	ATM6F048	AMK7F048	AMKDF09J (Light Silver) AMKDF09H (White) AMKDF09G (Black)	ADS3F048	AYR2F048
1AA1G547	AMZ7F017 (Ivory White)	ATM6F017 (Ivory White)	AMK7F017 (Ivory White)		ADS3F017 (Ivory White)	AYR2F017 (Ivory White)
1AC1G545	AMZ7F045	ATM6F045	AMK7F045		ADS3F045	AYR2F045
1AC1G559	AMZ7F059	ATM6F059	AMK7F059		ADS3F059	AYR2F059
1AA1G55A	AMZ7F05A	ATM6F05A	AMK7F05A		ADS3F05A	AYR2F05A
1AA1G54W	AMZ7F04W	ATM6F04W	AMK7F04W		ADS3F04W	AYR2F04W
1AC1G558	AMZ7F058	ATM6F058	AMK7F058		ADS3F058	AYR2F058

▲ The End cover and Aluminum end cover can be used as starters for vertical installation.

Product Name	Edge trim	Trim corner	Matching Metal Sheet	Shared-plate emboss	Steel Flashing Component	Single-sided Waterproof Tape
Shape Dimension Drawing						
Length	3,030 mm	—	1,000 mm x 10 m	331 mm x 37 m	3,030 mm	100 mm x 20 m
Qty per Package	20 Pcs/carton	50 Pcs/carton	1 Roll/carton	1 Roll/carton	10 Pcs/carton	1 Roll/bag
Color/pattern	Same color as main unit, flat	Same color as main unit, flat	Same color as main unit, flat	Same color and same pattern as main unit	Black	—
1AC1G548	AMK1F048	AMC5F048	ECL1F048	ECL1A048	KE5100	JF1526
1AA1G547	AMK1F017 (Ivory White)	AMC5F017 (Ivory White)	ECL1F017 (Ivory White)	—		
1AC1G545	AMK1F045	AMC5F045	ECL1F045	ECL1A045		
1AC1G559	AMK1F059	AMC5F059	ECL1F059	ECL3A059		
1AA1G55A	AMK1F05A	AMC5F05A	ECL1F05A	ECL1A05A		
1AA1G54W	AMK1F04W	AMC5F04W	ECL1F04W	—		
1AC1G558	AMK1F058	AMC5F058	ECL1F058	ECL1A058		

Product Name	Sealant	Touch-up Paint
Shape Dimension Drawing		
Length	—	—
Qty per Package	10 Pcs/carton (320 ml/pc)	1 Pc (15 ml/pc)
Color/pattern	Same color as main unit	Same color as main unit
1AC1G548	DSY1Q0K7 (Genuine White)	DPA4Q0UF
1AA1G547	DSY1Q0N8 (Ivory White)	DPA4Q0RK
1AC1G545	DSY1Q0N1	DPA4Q0UM
1AC1G559	DSY1Q0N3 (Rose Cream)	DPA4Q0UN
1AA1G55A	DSY1Q0N2 (Beige)	DPA4Q0RZ
1AA1G54W	DSY1Q0N6	DPA4Q0RY
1AC1G558	DSY1Q0K8 (Jet Black)	DPA4Q0UP

We also offer metal roofing.
Please feel free to reach out to us for more information.



* Photos are for illustrative purposes.

New Construction | Residential | 01

A bold, expansive roof defines the character of the entire exterior.

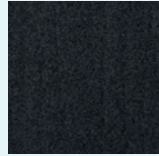

Nichiha Metal Roofing

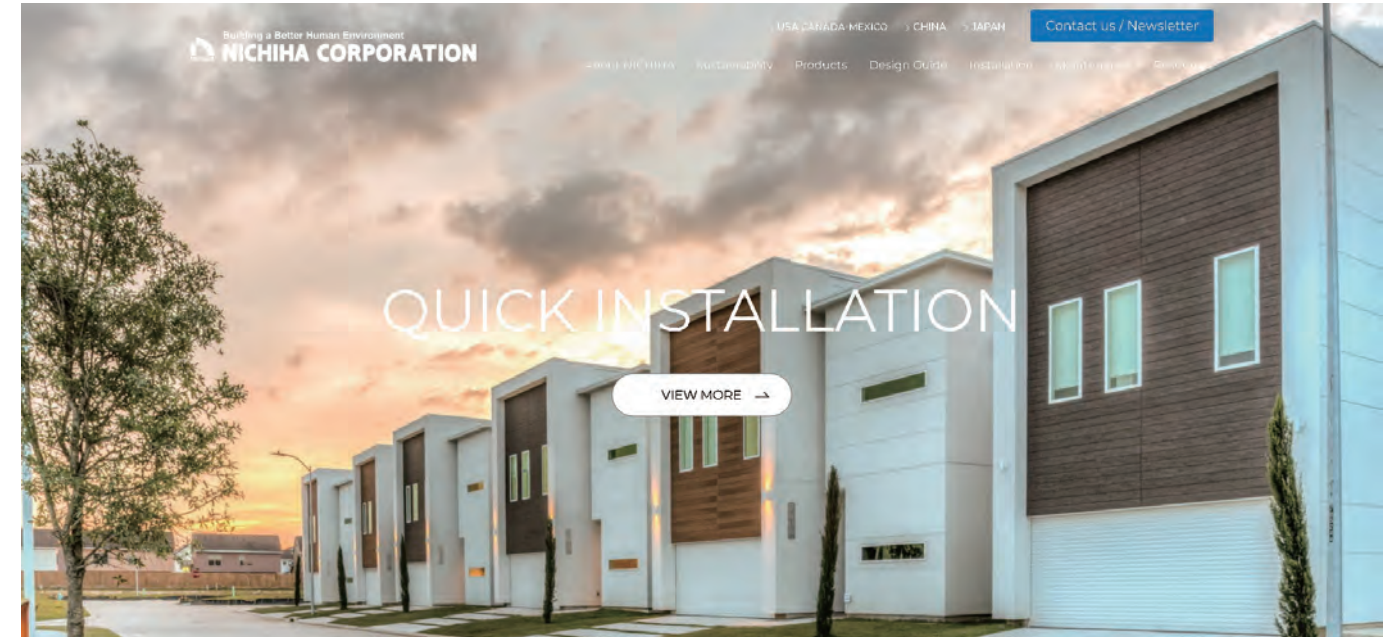

■ Featured products other than metal sidings

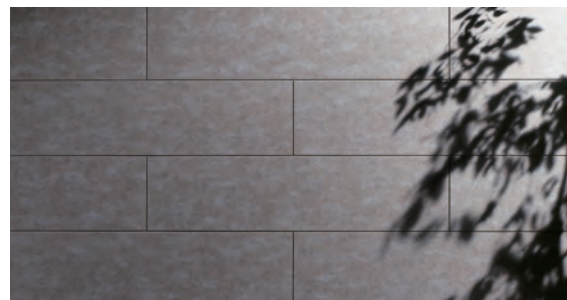

Fiber cement siding



Soffit

Company Profile

Company Name	NICHIHA CORPORATION	Headquarters	Nagoya, Aichi, Japan
Establishment	June 25, 1956	Sales office	(Domestic) 34 offices (Overseas subsidiaries) 3 companies
Capital	¥8,135 million yen	Plant	(Domestic) 9 Production bases (Overseas) 2 Production bases
Business details	Manufacture and sale of fiber cement sidings Sale of metal sidings, metal roofing Sales of hardboard and various building materials	Brand name	Nichiha EX series
Employees (consolidated)	3,158	Web site	https://www.nichiha.co.jp/global/



Expand your design
possibility with Nichiha.